

YOUR
SIGN
HERE

YOUR
SIGN
HERE

365 Central Avenue

Jersey City, New Jersey

Availabilities

Option A

- +/- 1,870 SF

Option B

- +/- 3,815 SF (Includes 8,000 SF Full Selling Basement)

Option C

- +/- 5,685 SF (Combined)

Site Description

- Strategically located in the heart of one of Jersey City's fastest growing markets along Central Avenue in what is known as "Jersey City Heights"
- Tremendous population density and strong average incomes
- Surrounded by new residential development, including a \$4MM streetscape renovation for Central Avenue that was just approved by the city and a 7-story residential development directly across the street
- Former urgent care center & retail store with full selling basement

Neighboring Retailers



Demographics

Radius	Total Population	Total Daytime Population	Average HH Income
1 Mile	60,320	49,916	\$72,502
3 Mile	459,139	429,667	\$81,798
5 Mile	837,117	781,248	\$101,092

Retail for Lease - Contact

Ryan Starkman
Ph. 732-724-4501
ryan@piersonre.com

PIERSON
COMMERCIAL REAL ESTATE®

365 Central Avenue

Jersey City, New Jersey

Market Aerial



State Map

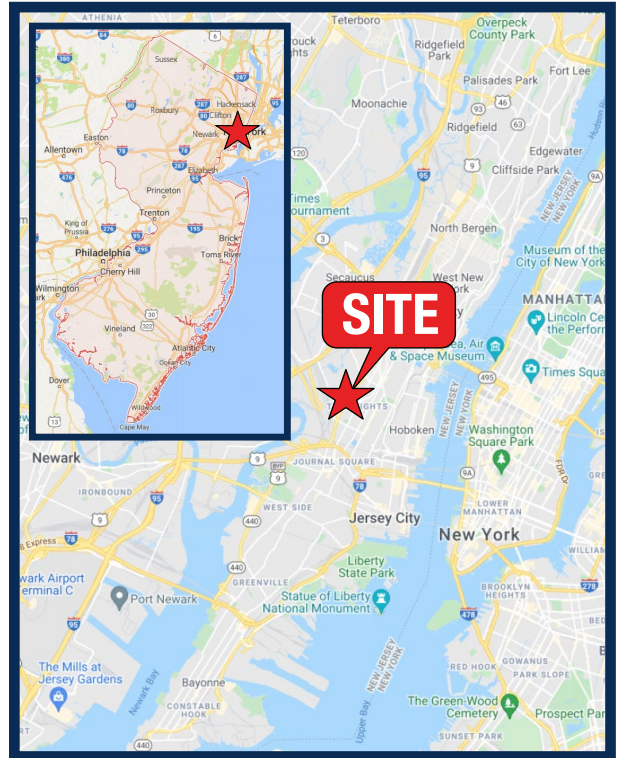

Site View

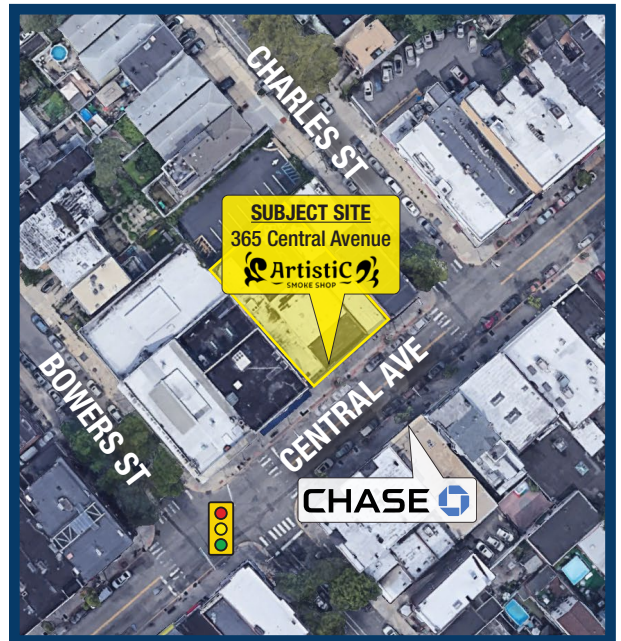

Retail for Lease - Contact

Ryan Starkman

Ph. 732-724-4501

ryan@piersonre.com

PIERSON
COMMERCIAL REAL ESTATE®

365 Central Avenue

Jersey City, New Jersey

Site Plan

GROUND FLOOR

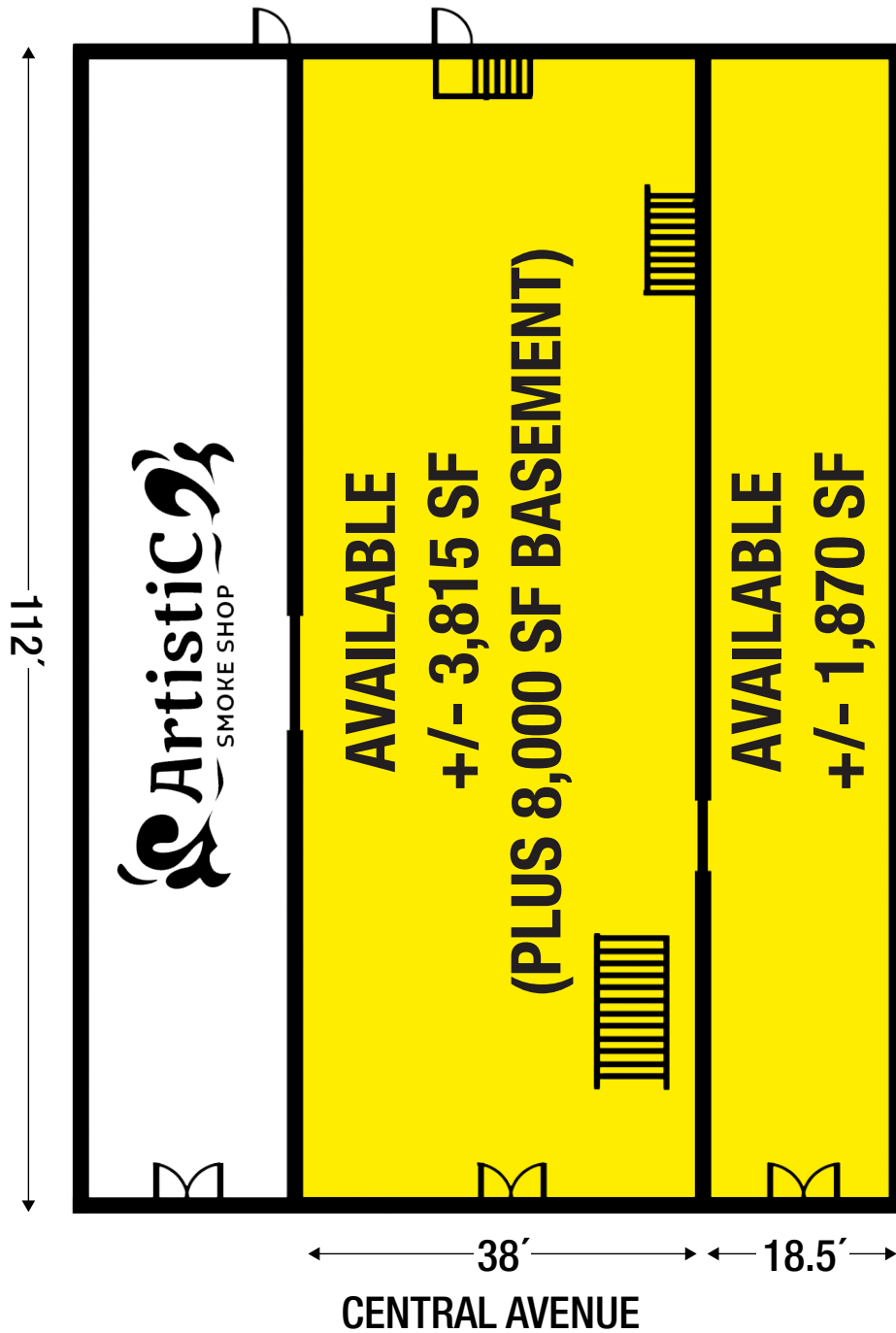

Retail for Lease - Contact

Ryan Starkman
Ph. 732-724-4501
ryan@piersonre.com

PIERSON
COMMERCIAL REAL ESTATE®

© Pierson Commercial Real Estate LLC. This information has been obtained from sources believed reliable. We have not verified it and make no guarantee, warranty or representation about it. Any renderings, mobile data, general data, projections, opinions, assumptions or estimates used are for example only and do not represent the current or future performance of the property. You and your advisors should conduct a careful, independent investigation of the property and data to determine to your satisfaction the suitability of the property for your needs.